

SECTION A-A

**UP Ultrapharma**

info@ultrapharma.com  
www.ultrapharma.com

1967 DB Heemskerk  
The Netherlands

T: +31-(0)251-207050  
F: +31-(0)251-207055

CONFIGURATION  
2"

DESCRIPTION:  
ASME BPE SNAP-ON Elastomer

The information contained in this drawing is the sole property of Ultrapharma BV. Any reproduction in part or as a whole without written permission of Ultrapharma BV is prohibited.

3RD ANGLE PROJECTION

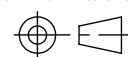

UNITS:  
mm

SCALE:  
1:1

SHEETSIZE  
A4